

GENERATORS

IONFIX PRO STATIC GENERATOR

IONFIX Pro range of high performance Static Generators delivers 150 watts of power at high voltages up to 30 kV or 60 kV.

IONFIX Pro has been designed for the most demanding electrostatic charging applications, providing comprehensive controllability, simplicity of use and high reliability.

Benefits and Advantages

IONFIX has been designed for ease of use.

- > Intuitive, ready to run controls.
- > High contrast LED screen.
- > LED indicators display status.
- > Simple menu structure to configure remote interface and access advanced settings.
- > Digital microprocessor control for dynamic response to changing load conditions.
- > Seamless transition between constant current and voltage modes.
- > Lockable settings.
- > Local and remote control of on/off, and current and voltage limits.
- > Flexible mounting options for bench top, under bench or wall mounting.



Specification

Output Voltage/Current:	Model 730150: 0–30 kV, in 0.1 kV steps. 5 mA max. Model 760150: 0–60 kV, in 0.1 kV steps. 2.5 mA max.
Polarity:	Positive or negative to be specified on order.
Power & Current Limitation:	150 W, all models. Current limit adjustable in 0.01 mA steps.
Input Voltage:	90-250 V, 50/60 Hz, 3 A max with IEC 320 connection. 2.8m cable.
Connections:	4 x generator electrodes can be connected.
Protection:	Overload, temperature and arc protection. Under / overvoltage protection. Remote interface protected against miswiring.
Standards:	Meets the latest harmonised electrical safety standard: IEC / EN / UL 62368-1. CE.
Rise time:	Fast rise times to give more power when it is needed. 30 kV < 60 ms. 60 kV < 100 ms. Fall time from full voltage 150 W load < 10 ms.
Ripple:	Output voltage ripple less than 5% at full output voltage.
Connectivity:	Remote interface for comprehensive control and monitoring with standard 25-way D-type connection. Optional fieldbus connectivity.

IONFIX Pro Generator_DS.Iss1

IONFIX Dimensions

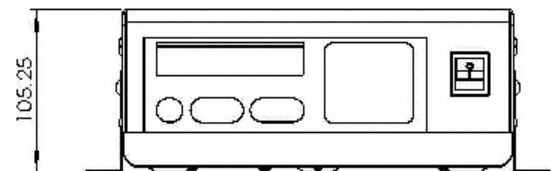
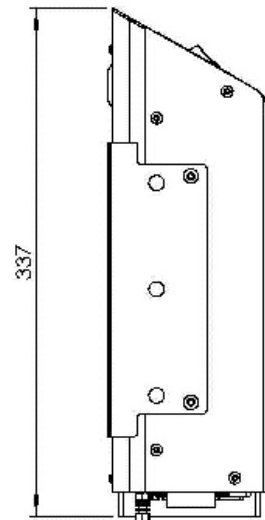
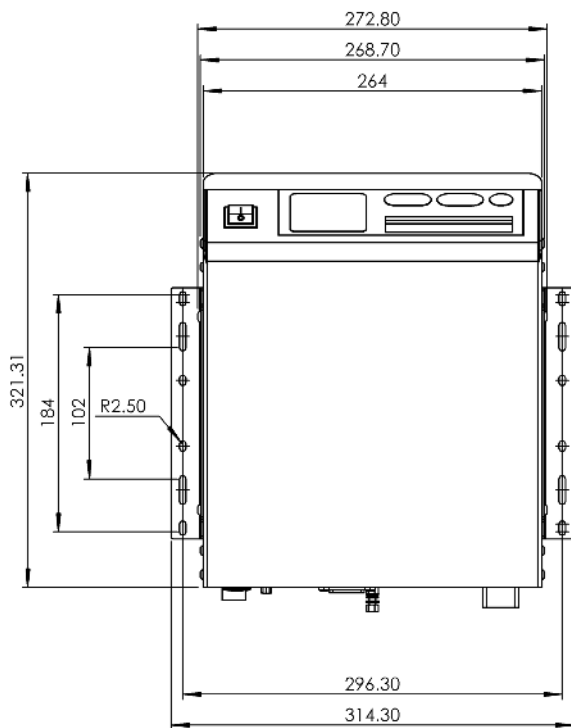

IONFIX Mounting Options

The IONFIX range has been designed for ease of use with brackets for flexible mounting.



Standard "bench top" fixing bracket position.



The brackets can be fitted to allow for "under bench" mounting.



The display and keypad can be rotated by 180° for wall mounting. Please specify "inverted display" on purchase orders.

IONFIX Pro Generator_DS.Iss1